

1 2 3 4 5 6 7 8

RevNo		Date	Signature	Checked

A
B
C
D
E
F

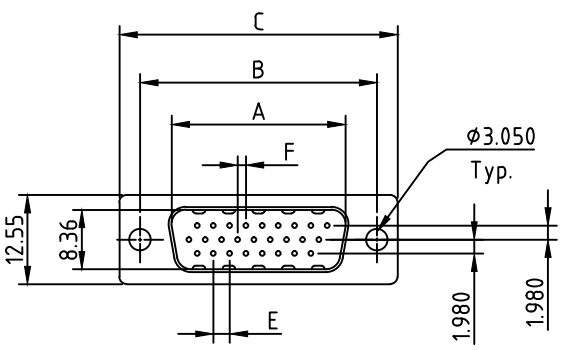

1 0 6 X X M X X X - - - - L F

D-Sub Solder Typ	15	26	44	62	Male	Vacant:Default PBT	P2:PA6T	P3:LCP	P4:PA9T	Vacant:No Screw	S:4.8	M:5.0	L:5.8
7.Full Nickel						Vacant::No Accessories	A After -Screw H=3.0	B After -Screw H=4.0	C After -Screw H=5.8	D Before -Screw H=5.8	E .Coalescent Nut H=5.8		
8.Nickel /But back-Shell:Tin						Vacant :Default 1u'	3. 3u'	5. 5u'	6. 10u'	7. 15u'	8. 30u'		
9.Tin													
11.Gold													
1.White													
3 Black													
4. Yellow													
6 Green													
9 Blue						1 Full Gold							
10. PC99						2 Half Gold							

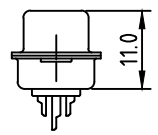
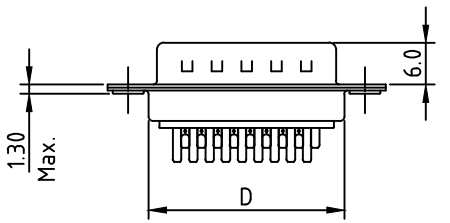

ELECTRICAL CHARACTERISTICS

Contact Current Rating: 3Amperes.
 Dielectric Withstanding Voltage: AC 500V at sea level.
 Insulation Resistance: 1000Megohms Min.
 Contact Resistance: 25Milliohms Max.
 Operation Temperature: -55°C to +105°C.

Material

Contact :Copper Alloy.
 Insulator:PBT. (Select PA6T /LCP /PA9T)
 Shell: SPCC.
 Screw: Copper Alloy.

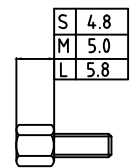

Note:

No.	A	B	C	D	E	F
15	16.92	24.99	30.81	19.23	2.29	1.145
26	25.25	33.32	39.14	27.56	2.29	1.145
44	38.96	47.04	53.04	41.28	2.29	1.145
62	55.42	63.50	69.32	57.33	2.41	1.205

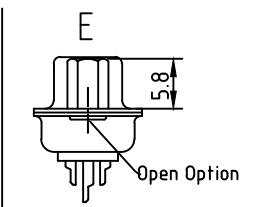
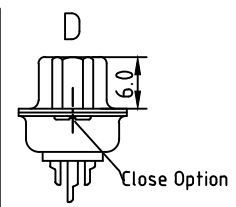
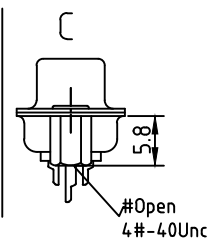
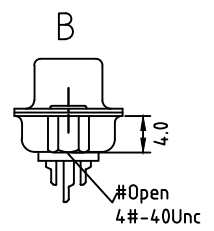
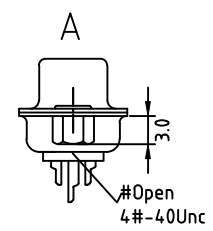

F

DRAW.BY	LinHaiFong	DATE	2005-10-10	UNIT	MM	TOLERANCE UNSPECIFIED	.X ±0.30 .XX ±0.25 .XXX ±0.150	Ang. ±2°	Chin Shong Enterprise CO., LTD.	ITEM	D-SUB H-D Male Solder
APPVL.BY		VERSION	A	SCALE		DWG.No.	F:/XX/ / +			PART No.	
										CUSTOMER	

1 2 3 4 5 6 7 8